



CENTRAL PARK

CITY WALK

REIMAGINE THE URBAN JUNGLE

LAUREL

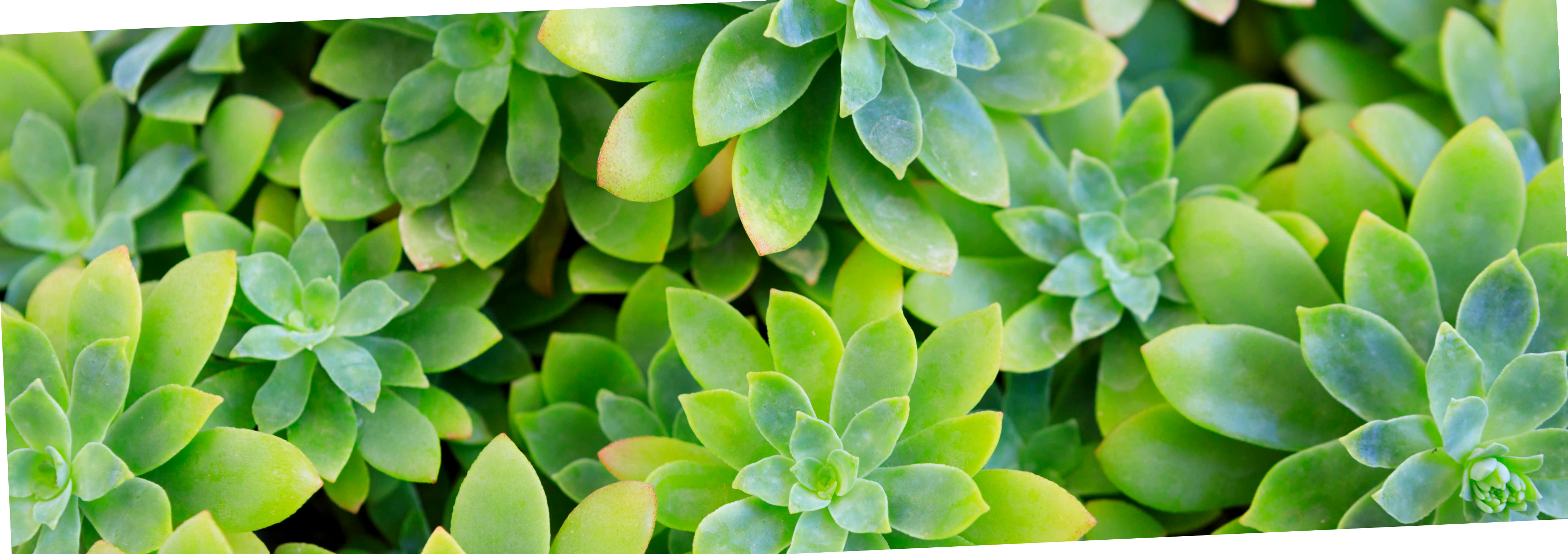



REIMAGINE THE URBAN JUNGLE

Big city living is by definition a fast-paced lifestyle set amongst high rises and bright lights. It is almost a blessing when you get to take refuge in a green space, away from the concrete surroundings. But what if we could blur the lines between urban and nature? Central Park at City Walk brings both of these worlds together. Premium homes and lush green landscapes set in the heart of Dubai create a true park lifestyle community that will make you reimagine what the urban jungle is.





MEERAAS

Meraas has illustrated its position as a leading master developer by creating and consistently delivering residential developments that strengthen Dubai's position as a global real estate investment destination of choice. Meraas has built a powerful legacy of developing creative spaces and establishing recognisable landmarks, leading to enriching lifestyle experiences for its residents.

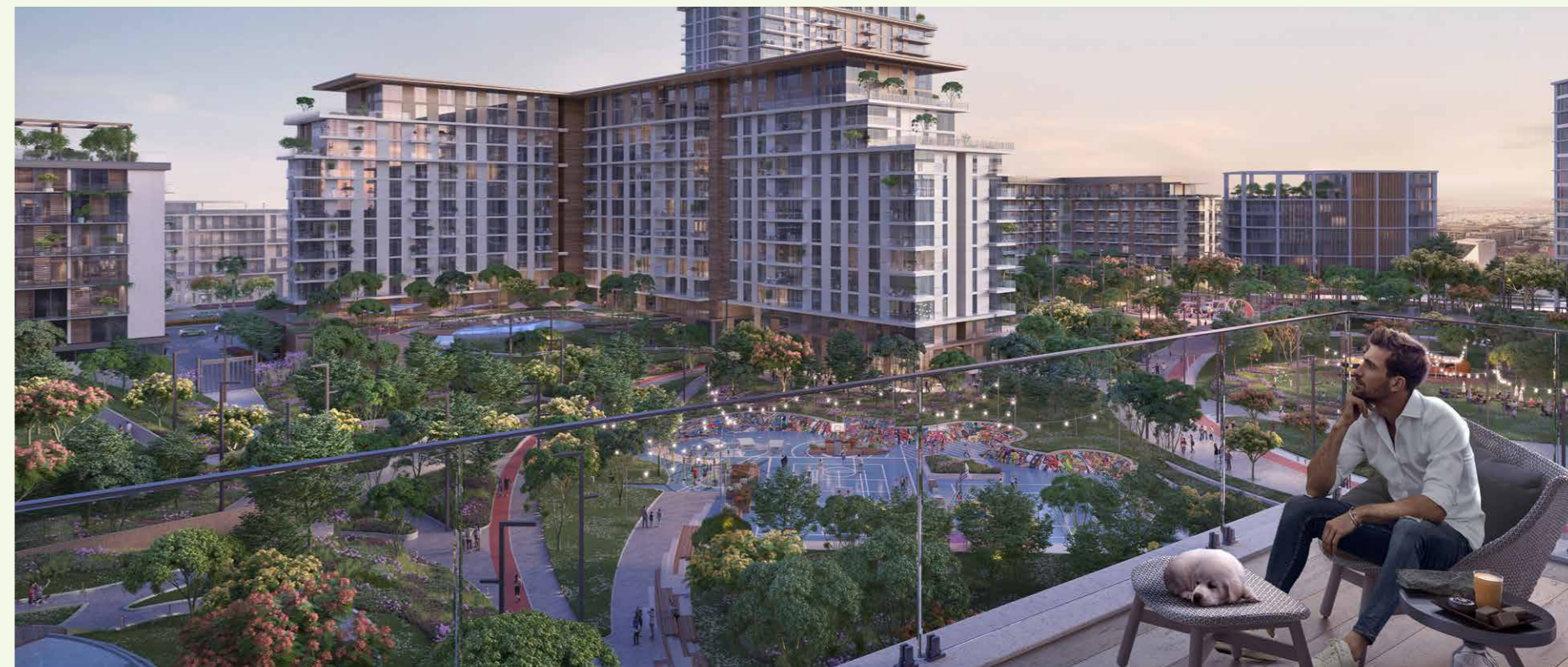

Its cutting-edge portfolio comprises of leading developments across waterfront, urban, and suburban locations in Dubai, such as City Walk Residences, Bluewaters Residences, Nikki Beach Residences, BVLGARI Residences and Port de La Mer, to name but a few. Meraas is synonymous with sophistication and innovation and offers best in class residential developments that appeal to a discerning, global customer.

CITY WALK

City Walk is a creative lifestyle space to live, work and play in the heart of Dubai. Conceptualised by world-renowned designers, this high-end destination includes international retail offerings, upscale gourmet restaurants, world-class residences, and luxurious hotels, combining Dubai's love of out-of-the-box thinking with contemporary convenience. Built around movement, sharing, and community, the modern urban mix and easy connectivity make it one of the most prominent and recognisable neighbourhoods in Dubai.





CONNECTIVITY

Connected to well-established road networks and highways, while being ideally located between Al Wasl Road and Sheikh Zayed Road, Central Park at City Walk is ideally placed for quick and convenient access to major landmarks in Dubai.

1
MINUTE FROM
CITY WALK MALL

15
MINUTES TO
BURJ AL ARAB

20
MINUTES TO
THE PALM JUMEIRAH

5
MINUTES FROM
COCA-COLA ARENA

15
MINUTES TO
DUBAI INT. AIRPORT

20
MINUTES TO
DUBAI MARINA

10
MINUTES TO
JUMEIRAH BEACH

15
MINUTES TO
LA MER BEACH

50
MINUTES TO
AL MAKTOUM INT. AIRPORT

Imagine waking up in the heart of the city but opening your curtains and seeing nothing but lush greenery, with a backdrop of the magnificent Dubai skyline. Imagine stepping outside and being able to take part in countless activities all within your own private park. Imagine all of this being surrounded by some of the city's finest restaurants, world-class hotels, massive shopping centres and amazing leisure and entertainment outlets. You don't have to imagine anymore — live re-energised by nature in Central Park at City Walk.



CENTRAL PARK AT CITY WALK





AMENITIES

Central Park at City Walk features such a wide range of facilities and amenities that they cannot all be found in any community in the city. There is something for all age groups to enjoy.



Pools and water play areas | Kids play area | Running track | Dog park | Multi-use games and sports lawns | Tennis and squash courts | Half-court basketball | Skateable landscape | Games tables | Outdoor gym and fitness station | Spa and sauna
Yoga and meditation areas | Dining outlets and retail stores | Function rooms | Nursery | Events area
Picnic pavilions | Outdoor barbeque areas

LAUREL

Laurel offers a stunning view of the evergreen Central Park. Along with the view, the signature design elements that Central Park has become to be known for are prevalent, fusing modern architectural design with the lush surroundings. Laurel comprises of 1, 2, 3 and 4-bedroom apartments as well as 2 exclusive penthouses.



*STATE-OF-THE-ART
FITNESS CENTRE*

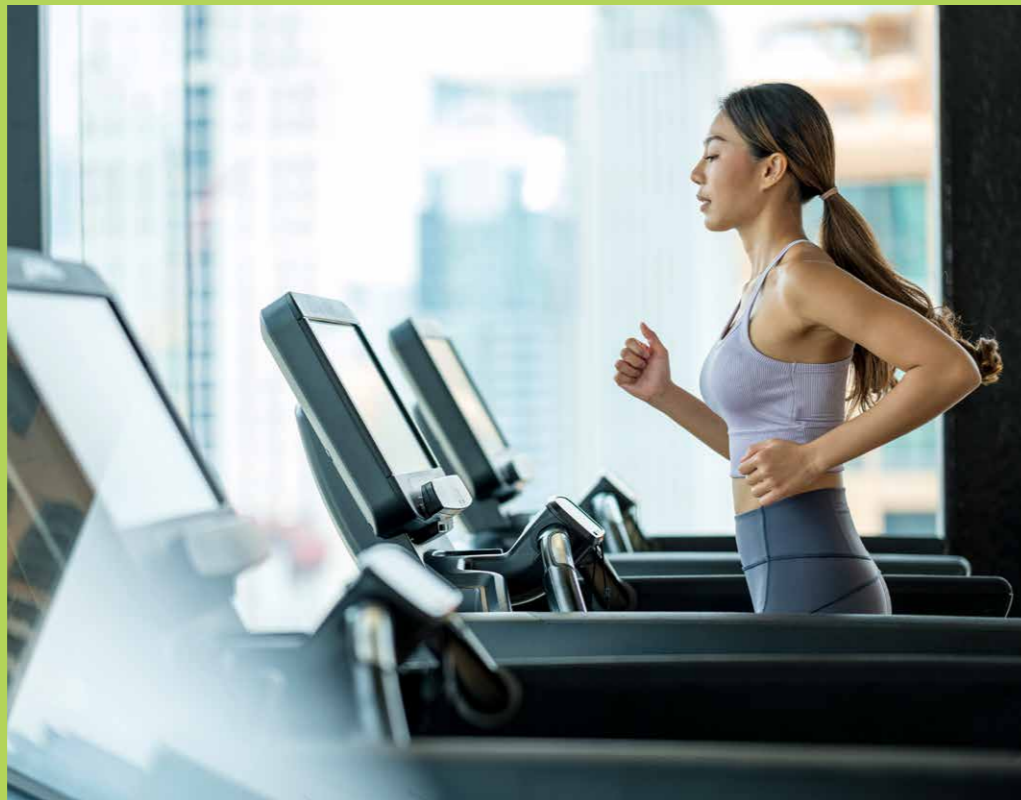

*TO KEEP HEALTHY AND
IN GOOD SHAPE*





*EXPANSIVE LAWNS WITH
FUN ACTIVITIES*



*FOR THE ENTIRE FAMILY
TO ENJOY*

*EVERYTHING
YOU NEED*



*JUST AROUND
THE CORNER*





For more information or to book a viewing tour get in touch
with our Off Plan & Investment team today:

+971 4 302 5800

info@hausandhaus.com

www.hausandhaus.com

'Agency of the Year 2020 Dubai' – Voted by @bayut and dubizzle