



## Downtown Views II T2, Downtown Dubai

haus & haus Real Estate Broker | [www.hausandhaus.com](http://www.hausandhaus.com)

Mehron Mashayekh, Consultant | +971 (0) 4 302 5842 | +971 (0) 58 595 8816 | [mehron@hausandhaus.com](mailto:mehron@hausandhaus.com)

haus&haus



# Downtown Views II T2

Downtown Dubai

 2  2  1217 sq.ft

## Property Description

Spacious two-bedroom corner apartment in the new Downtown Views II T2 development with Dubai Skyline views. Offering a very attractive post-handover payment plan. Handover expected early 2023. With a modern bright finish, and short proximity to The Dubai Mall, this EMAAR development is very popular.



## Property Features

- Designed by Renowned Emaar Properties
- Fantastic opportunity to invest in thriving Downtown
- Spacious Two Bedroom
- Re-Sale
- 2 x Balcony
- Zabeel District
- Next to Downtown
- 48 Month Post-Handover Payment Plan
- Amount Required for Transfer Including fees 1,126,238

Asking Price: AED 2,340,000

DOWNTOWN  
VIEWS II



TOWER 2  
2 BEDROOM W/BALCONY

|              |                               |
|--------------|-------------------------------|
| Suite Area   | 1004.27 Sq.ft. / 93.30 Sq.m.  |
| Balcony Area | 213.02 Sq.ft. / 19.79 Sq.m.   |
| Total Area   | 1217.29 Sq.ft. / 113.09 Sq.m. |

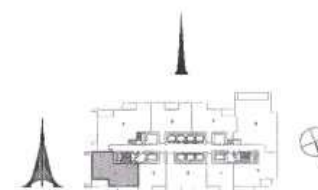

# Downtown Views II T2

Downtown Dubai







For viewing and more information,  
please contact our property specialist:



## Mehron Mashayekh

Consultant | BRN: 47821

t: +971 (0) 4 302 5842

m: +971 (0) 58 595 8816

e: [mehron@hausandhaus.com](mailto:mehron@hausandhaus.com)

### Disclaimer

Every attempt has been made to ensure accuracy, however these property particulars are approximate and for illustrative purposes only. They have been prepared in good faith and they are not intended to constitute part of an offer of contract. We have not carried out a structural survey and the services, appliances and specific fittings have not been tested. All photographs, measurements, floor plans and distances referred to

are given as a guide only and should not be relied upon for the purchase of any fixture or fittings. Lease details, service charges and ground rent (where applicable) are given as a guide only and should be checked prior to agreeing a sale. The copyright of details, photographs and floor plans remain exclusive to haus & haus Real Estate Broker.